

COOL 1

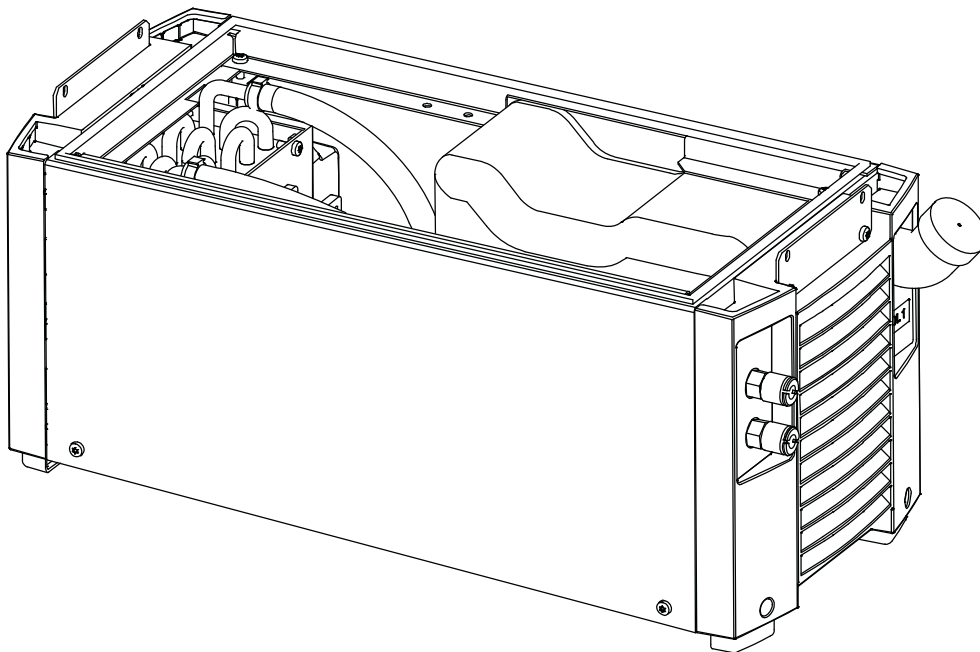

Instruction manual



DECLARATION OF CONFORMITY

According to

The Low Voltage Directive 2006/95/EC, entering into force 16 January 2007

The EMC Directive 2004/108/EC, entering into force 20 July 2007

Type of equipment

Arc welding cooling unit

Type designation

COOL 1, from serial number 033 xxx xxxx (2010 w.33)

Brand name or trade mark

ESAB

Manufacturer or his authorized representative established within the EEA:

Name, address, phone, website:

ESAB AB

Lindholmsallén 9

Box 8004, 402 77 GÖTEBORG, Sweden

Phone: +46 31 509 000

Website: www.esab.com

The following harmonized standards, in force within the EEA, has been used in the design:

EN 60974-2, Arc welding equipment – Part 2: Liquid cooling systems

EN 60974-10, Arc welding equipment – Part 10: Electromagnetic compatibility (EMC) requirements

Additional information:

Restrictive use, Class A equipment, intended for use in locations other than residential.

By signing this document, the undersigned declares as manufacturer, or the manufacturer's authorized representative established within EEA, that the equipment in question complies with the safety requirements stated above.

Date

2012-09-27

Signature

A handwritten signature in black ink, appearing to be "JF", written over a light blue horizontal line.

Jerker Funnemark
Clarification

Position

Managing Director
Equipment & Automation

1 SAFETY	4
2 INTRODUCTION	6
2.1 Equipment	6
3 TECHNICAL DATA	6
4 INSTALLATION	6
4.1 Location	6
4.2 Power supply	6
4.3 Installing welding equipment	7
5 OPERATION	7
5.1 Connections and control devices	7
5.2 Coolant connection	7
5.3 Coolant pressure switch	7
5.4 Water flow guard - option	8
6 MAINTENANCE	8
6.1 Inspection and cleaning	8
6.2 Filling the coolant	8
7 FAULT-TRACING	9
8 ORDERING SPARE PARTS	9
ASSEMBLY INSTRUCTIONS	10
DIAGRAM	11
PUMP DATA,	12
COOLING CHARACTERISTIC	13
ORDER NUMBER	14
ACCESSORIES	15

1 SAFETY

Users of ESAB equipment have the ultimate responsibility for ensuring that anyone who works on or near the equipment observes all the relevant safety precautions. Safety precautions must meet the requirements that apply to this type of equipment. The following recommendations should be observed in addition to the standard regulations that apply to the workplace.

All work must be carried out by trained personnel well-acquainted with the operation of the equipment. Incorrect operation of the equipment may lead to hazardous situations which can result in injury to the operator and damage to the equipment.

1. Anyone who uses the equipment must be familiar with:
 - its operation
 - location of emergency stops
 - its function
 - relevant safety precautions
 - welding and cutting
2. The operator must ensure that:
 - no unauthorised person is stationed within the working area of the equipment when it is started up.
 - no-one is unprotected when the arc is struck
3. The workplace must:
 - be suitable for the purpose
 - be free from drafts
4. Personal safety equipment
 - Always wear recommended personal safety equipment, such as safety glasses, flame-proof clothing, safety gloves.
 - Do not wear loose-fitting items, such as scarves, bracelets, rings, etc., which could become trapped or cause burns.
5. General precautions
 - Make sure the return cable is connected securely.
 - Work on high voltage equipment **may only be carried out by a qualified electrician.**
 - Appropriate fire extinguishing equipment must be clearly marked and close at hand.
 - Lubrication and maintenance must **not** be carried out on the equipment during operation.



WARNING



Arc welding and cutting can be injurious to yourself and others. Take precautions when welding and cutting. Ask for your employer's safety practices which should be based on manufacturers' hazard data.

ELECTRIC SHOCK - Can kill

- Install and earth the unit in accordance with applicable standards.
- Do not touch live electrical parts or electrodes with bare skin, wet gloves or wet clothing.
- Insulate yourself from earth and the workpiece.
- Ensure your working stance is safe.

FUMES AND GASES - Can be dangerous to health

- Keep your head out of the fumes.
- Use ventilation, extraction at the arc, or both, to take fumes and gases away from your breathing zone and the general area.

ARC RAYS - Can injure eyes and burn skin.

- Protect your eyes and body. Use the correct welding screen and filter lens and wear protective clothing.
- Protect bystanders with suitable screens or curtains.

FIRE HAZARD

- Sparks (spatter) can cause fire. Make sure therefore that there are no inflammable materials nearby.

NOISE - Excessive noise can damage hearing

- Protect your ears. Use earmuffs or other hearing protection.
- Warn bystanders of the risk.

MALFUNCTION - Call for expert assistance in the event of malfunction.

Read and understand the instruction manual before installing or operating.

PROTECT YOURSELF AND OTHERS!



CAUTION

Read and understand the instruction manual before installing or operating.

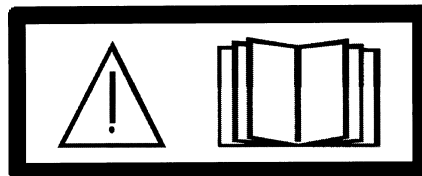

CAUTION

Class A equipment is not intended for use in residential locations where the electrical power is provided by the public low-voltage supply system. There may be potential difficulties in ensuring electromagnetic compatibility of class A equipment in those locations, due to conducted as well as radiated disturbances.

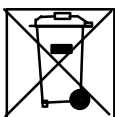
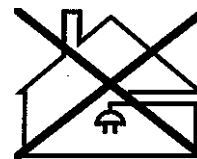

Dispose of electronic equipment at the recycling facility!

In observance of European Directive 2002/96/EC on Waste Electrical and Electronic Equipment and its implementation in accordance with national law, electrical and/or electronic equipment that has reached the end of its life must be disposed of at a recycling facility.

As the person responsible for the equipment, it is your responsibility to obtain information on approved collection stations.

For further information contact the nearest ESAB dealer.

ESAB can provide you with all necessary welding protection and accessories.

2 INTRODUCTION

Cooling unit **COOL 1** is intended for cooling water-cooled MIG/MAG welding guns. **ESAB's accessories for the product can be found on page 15.**

2.1 Equipment

The cooling unit is supplied with an installation instructions and instruction manual.

3 TECHNICAL DATA

COOL 1	
Power consumption	24V DC / 2A
Cooling power	1.3 kW
Noise (Constant sound pressure when idling)	< 70 dB (A)
Coolant	ready mixed (see accessories on page 15)
Coolant quantity	4.5 l
Maximum water flow	2.0 l/min
Max pressure lift for torch Q_{max}	4 bar
Operating temperature	-10° to +40°C
Transportation temperature	-20° to +55°C
Dimensions l x w x h	610 x 256 x 256 mm
Weight empty	12 kg
Enclosure class	IP23

Enclosure class

The **IP** code indicates the enclosure class, i. e. the degree of protection against penetration by solid objects or water. Equipment marked **IP23** is designed for indoor and outdoor use.

4 INSTALLATION

The installation must be carried out by a professional.



CAUTION

This product is intended for industrial use. In a domestic environment this product may cause radio interference. It is the user's responsibility to take adequate precautions.

4.1 Location

Position the cooling unit such that its cooling air inlets and outlets are not obstructed.

4.2 Power supply

The cooling unit is supplied from the power source, see page 10.

4.3 Installing welding equipment

See installation instructions on page 10.

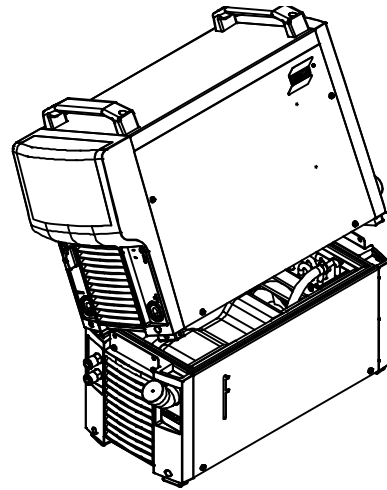

5 OPERATION

General safety regulations for handling the equipment can be found on page 4. Read through before you start using the equipment!

5.1 Connections and control devices

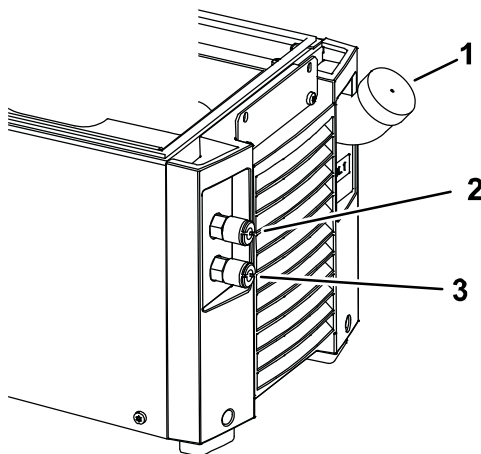

- 1 Filling the coolant
- 2 Connection BLUE for coolant from cooling unit
- 3 Connection RED for coolant (return) to cooling unit.

5.2 Coolant connection

For problem free operation it is recommended that the height from the cooling unit to the water-cooled MIG/MAG gun is a maximum of 8.5 m.

5.3 Coolant pressure switch

The pump has an enclosed coolant pressure switch. The switch opens if the coolant pressure is too high. This can occur if a hose is folded, which makes the flow to fail or stop.

The pump motor and cooling fan are connected in parallel and powered from the power source. The welding process, the pump and the fan can not be restarted until the sensor circuit is closed.

The MMC panel of the system displays fault code 29 - No cooling water flow. Check if a hose is folded and reset the fault code by pressing any button on the control panel.

5.4 Water flow guard - option

The water flow guard blocks the power source if the coolant stops (minimum water flow of 0.7 l/m). The water flow guard is an accessory, see page 15.

6 MAINTENANCE

Regular maintenance is important for safe, reliable operation.

Only those persons who have appropriate electrical knowledge (authorized personnel) may remove the safety plates.



CAUTION

All guarantee undertakings from the supplier cease to apply if the customer attempts any work to rectify any faults in the product during the guarantee period.

6.1 Inspection and cleaning



WARNING

The mains supply must be disconnected before cleaning.

Dust, grinding swarf etc The air stream through the cooling unit carries particles that become trapped in the cooling element, particularly in dirty working environments. This results in reduced cooling capacity. For this reason, blow clean using compressed air at regular intervals.

The coolant system - The recommended coolant must be used in the system otherwise clumps can be created that block the pump, water connections or elements. Flushing can only be performed via red water connection. Then drain the tank manually, i.e. empty via the tank's filling hole.

6.2 Filling the coolant

ESAB's coolant is recommended for use. See accessories, see page 15

- Fill with coolant.
(The fluid level must not exceed the upper marking but neither must it be below the lower marking)

Note! Coolant must be topped up if connecting a welding gun or coolant hoses that are 5 metres in length or longer. When adjusting the water level by topping up, the coolant hoses do not need to be disconnected.

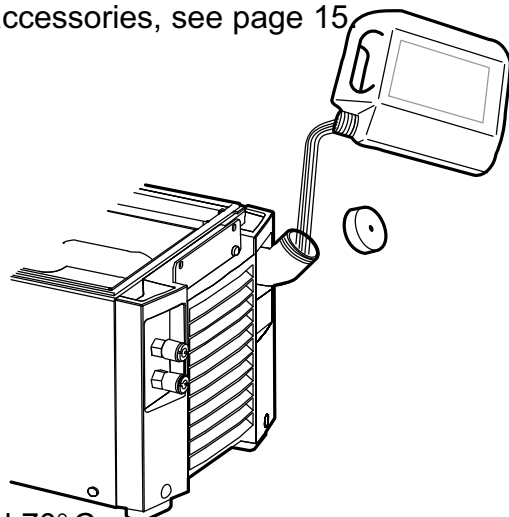

The temperature of the coolant must not exceed 70° C



CAUTION

The coolant must be handled as chemical waste.

7 FAULT-TRACING

Try these recommended checks and inspections before sending for an authorized service technician.

Error code	Corrective action
Poor cooling effect	<ul style="list-style-type: none">• Clean the cooling element using compressed air.• Check the coolant level.

8 ORDERING SPARE PARTS

Repair and electrical work should be performed by an authorised ESAB service technician. Use only ESAB original spare and wear parts.

COOL 1 is designed and tested in accordance with the international and European standards EN 60974-2 and EN 60974-10. It is the obligation of the service unit which has carried out the service or repair work to make sure that the product still conforms to the said standard.

Spare parts may be ordered through your nearest ESAB dealer, see the last page of this publication.

Assembly instructions

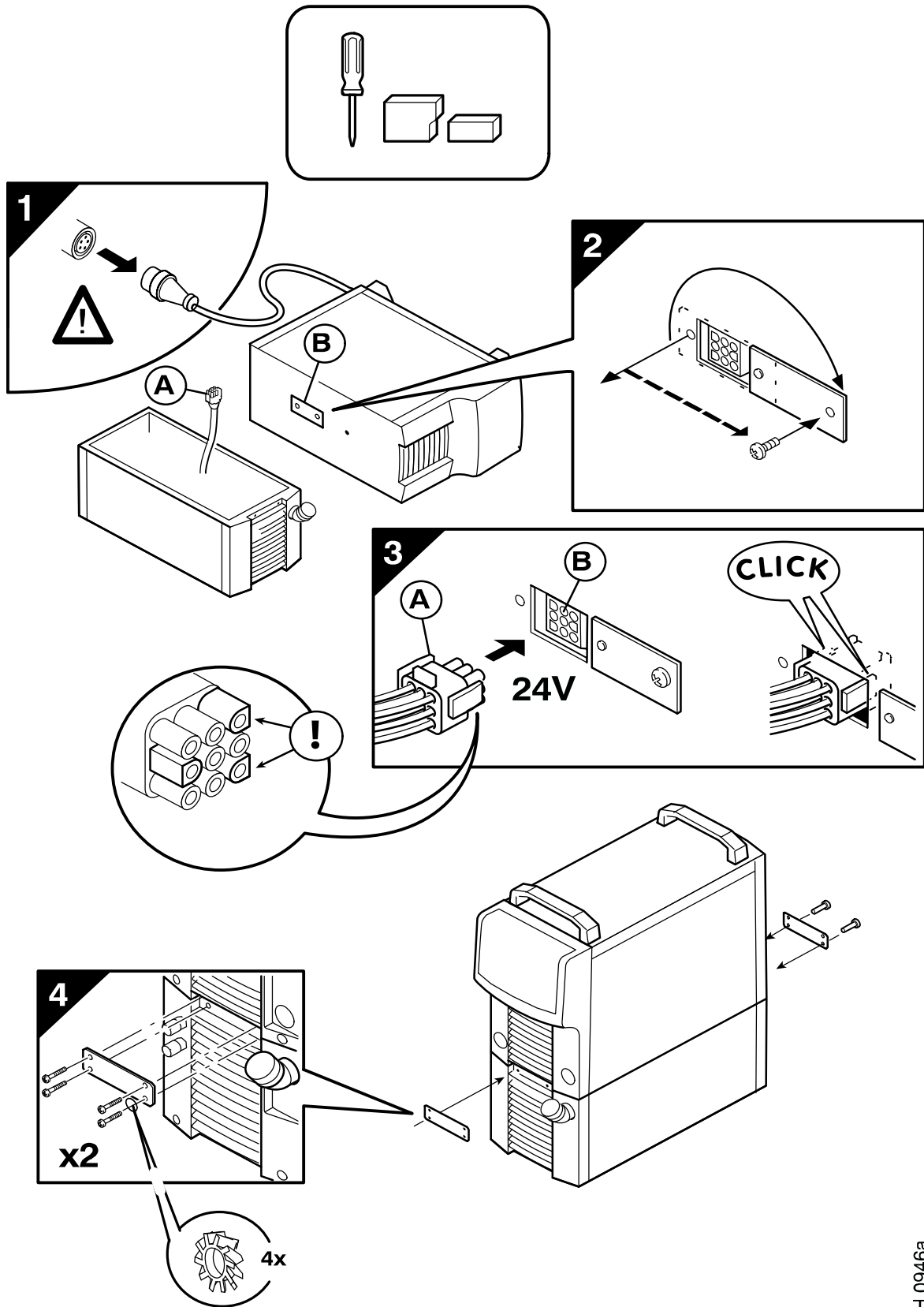

AH 0946a

Diagram

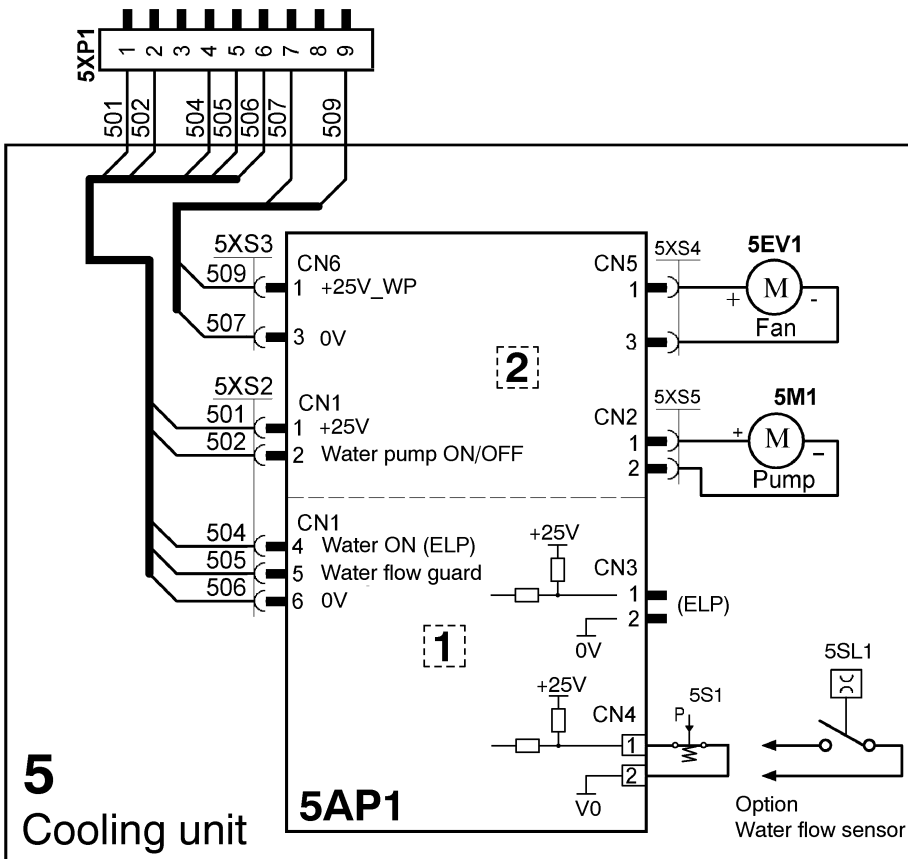
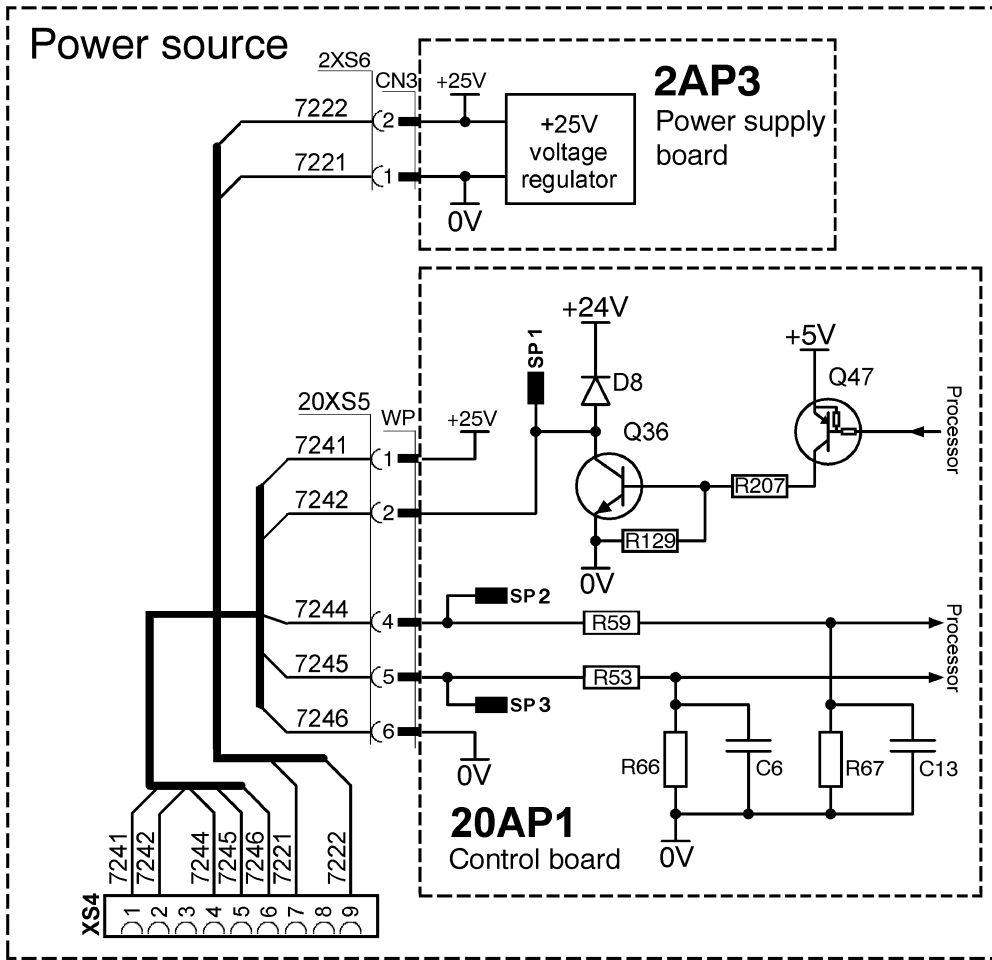

Pump data,

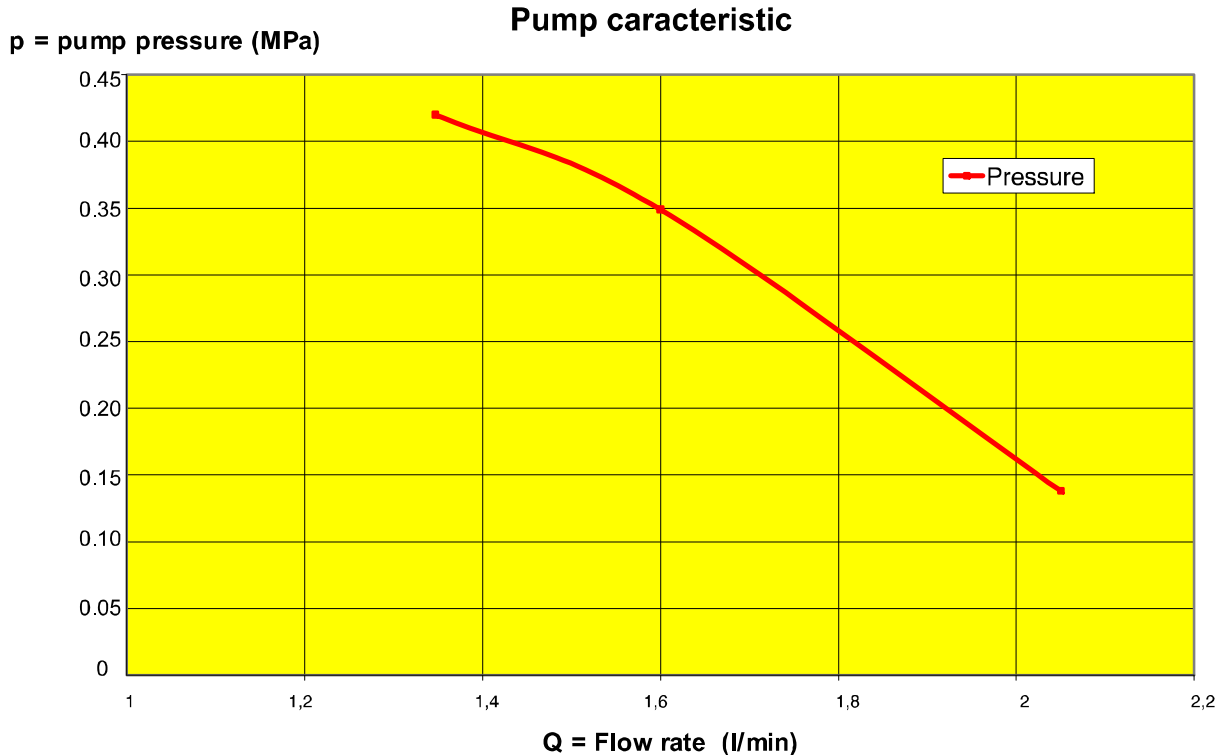

p = Pump pressure,

Q = Flow rate,

Cooling characteristic

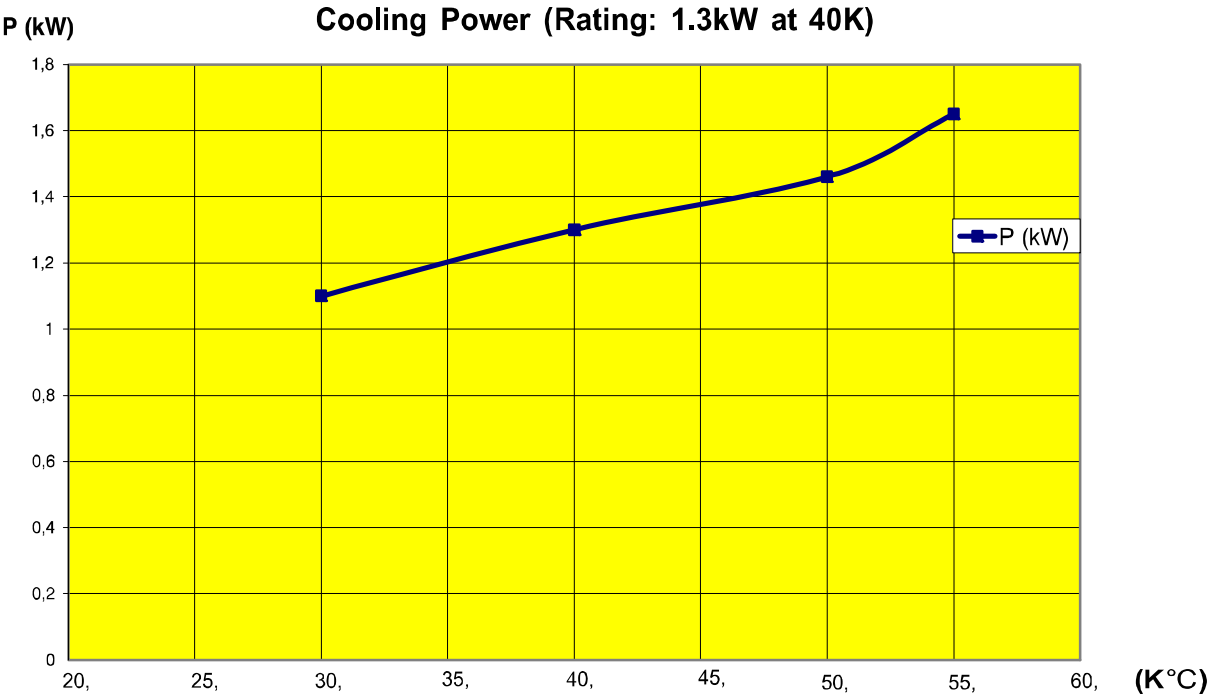

K = The temperature difference between inlet water temperature and ambient temperature (K)

P = Power,

K°C = temperature difference,

COOL 1

Order number

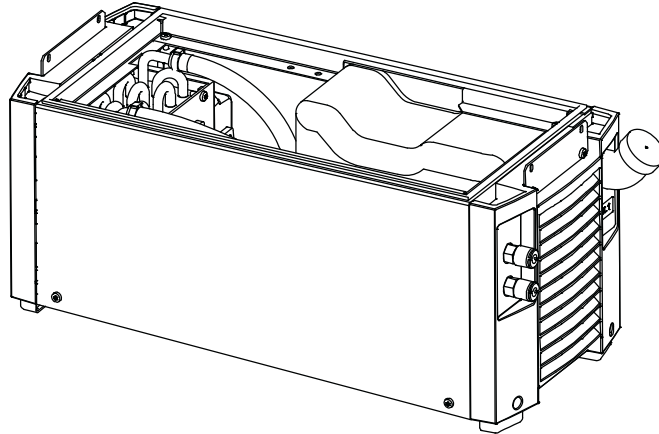

Ordering no.	Denomination	Type	Notes
0462 300 880	Cooling unit complete	Cool 1	
0459 839 048	Spare parts list	Cool 1	

Instruction manuals in other languages can be downloaded from the website, www.esab.com.

COOL 1

Accessories

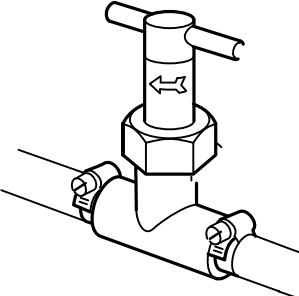
	Coolant (ready mixed) 50% water and 50% mono-ethylene glycol (10 l) 0007 810 012
	Water flow guard 0456 855 881

ESAB subsidiaries and representative offices

Europe

AUSTRIA

ESAB Ges.m.b.H
Vienna-Liesing
Tel: +43 1 888 25 11
Fax: +43 1 888 25 11 85

BELGIUM

S.A. ESAB N.V.
Brussels
Tel: +32 2 745 11 00
Fax: +32 2 745 11 28

BULGARIA

ESAB Kft Representative Office
Sofia
Tel/Fax: +359 2 974 42 88

THE CZECH REPUBLIC

ESAB VAMBERK s.r.o.
Vamberk
Tel: +420 2 819 40 885
Fax: +420 2 819 40 120

DENMARK

Aktieselskabet ESAB
Herlev
Tel: +45 36 30 01 11
Fax: +45 36 30 40 03

FINLAND

ESAB Oy
Helsinki
Tel: +358 9 547 761
Fax: +358 9 547 77 71

FRANCE

ESAB France S.A.
Cergy Pontoise
Tel: +33 1 30 75 55 00
Fax: +33 1 30 75 55 24

GERMANY

ESAB GmbH
Solingen
Tel: +49 212 298 0
Fax: +49 212 298 218

GREAT BRITAIN

ESAB Group (UK) Ltd
Waltham Cross
Tel: +44 1992 76 85 15
Fax: +44 1992 71 58 03

ESAB Automation Ltd
Andover
Tel: +44 1264 33 22 33
Fax: +44 1264 33 20 74

HUNGARY

ESAB Kft
Budapest
Tel: +36 1 20 44 182
Fax: +36 1 20 44 186

ITALY

ESAB Saldatura S.p.A.
Bareggio (Mi)
Tel: +39 02 97 96 8.1
Fax: +39 02 97 96 87 01

THE NETHERLANDS

ESAB Nederland B.V.
Amersfoort
Tel: +31 33 422 35 55
Fax: +31 33 422 35 44

NORWAY

AS ESAB
Larvik
Tel: +47 33 12 10 00
Fax: +47 33 11 52 03

POLAND

ESAB Sp.zo.o.
Katowice
Tel: +48 32 351 11 00
Fax: +48 32 351 11 20

PORTUGAL

ESAB Lda
Lisbon
Tel: +351 8 310 960
Fax: +351 1 859 1277

ROMANIA

ESAB Romania Trading SRL
Bucharest
Tel: +40 316 900 600
Fax: +40 316 900 601

RUSSIA

LLC ESAB
Moscow
Tel: +7 (495) 663 20 08
Fax: +7 (495) 663 20 09

SLOVAKIA

ESAB Slovakia s.r.o.
Bratislava
Tel: +421 7 44 88 24 26
Fax: +421 7 44 88 87 41

SPAIN

ESAB Ibérica S.A.
Alcalá de Henares (MADRID)
Tel: +34 91 878 3600
Fax: +34 91 802 3461

SWEDEN

ESAB Sverige AB
Gothenburg
Tel: +46 31 50 95 00
Fax: +46 31 50 92 22

ESAB international AB
Gothenburg
Tel: +46 31 50 90 00
Fax: +46 31 50 93 60

SWITZERLAND

ESAB AG
Dietikon
Tel: +41 1 741 25 25
Fax: +41 1 740 30 55

UKRAINE

ESAB Ukraine LLC
Kiev
Tel: +38 (044) 501 23 24
Fax: +38 (044) 575 21 88

North and South America

ARGENTINA

CONARCO
Buenos Aires
Tel: +54 11 4 753 4039
Fax: +54 11 4 753 6313

BRAZIL

ESAB S.A.
Contagem-MG
Tel: +55 31 2191 4333
Fax: +55 31 2191 4440

CANADA

ESAB Group Canada Inc.
Mississauga, Ontario
Tel: +1 905 670 02 20
Fax: +1 905 670 48 79

MEXICO

ESAB Mexico S.A.
Monterrey
Tel: +52 8 350 5959
Fax: +52 8 350 7554

USA

ESAB Welding & Cutting Products
Florence, SC
Tel: +1 843 669 44 11
Fax: +1 843 664 57 48

Asia/Pacific

AUSTRALIA

ESAB South Pacific
Archerfield BC QLD 4108
Tel: +61 1300 372 228
Fax: +61 7 3711 2328

CHINA

Shanghai ESAB A/P
Shanghai
Tel: +86 21 2326 3000
Fax: +86 21 6566 6622

INDIA

ESAB India Ltd
Calcutta
Tel: +91 33 478 45 17
Fax: +91 33 468 18 80

INDONESIA

P.T. ESABindo Pratama
Jakarta
Tel: +62 21 460 0188
Fax: +62 21 461 2929

JAPAN

ESAB Japan
Tokyo
Tel: +81 45 670 7073
Fax: +81 45 670 7001

MALAYSIA

ESAB (Malaysia) Snd Bhd
USJ
Tel: +603 8023 7835
Fax: +603 8023 0225

SINGAPORE

ESAB Asia/Pacific Pte Ltd
Singapore
Tel: +65 6861 43 22
Fax: +65 6861 31 95

SOUTH KOREA

ESAB SeAH Corporation
Kyungnam
Tel: +82 55 269 8170
Fax: +82 55 289 8864

UNITED ARAB EMIRATES

ESAB Middle East FZE
Dubai
Tel: +971 4 887 21 11
Fax: +971 4 887 22 63

Africa

EGYPT

ESAB Egypt
Dokki-Cairo
Tel: +20 2 390 96 69
Fax: +20 2 393 32 13

SOUTH AFRICA

ESAB Africa Welding & Cutting Ltd
Durbanvill 7570 - Cape Town
Tel: +27 (0)21 975 8924

Distributors

For addresses and phone numbers to our distributors in other countries, please visit our home page

www.esab.com



www.esab.com

